

HANDLE SECTIONS

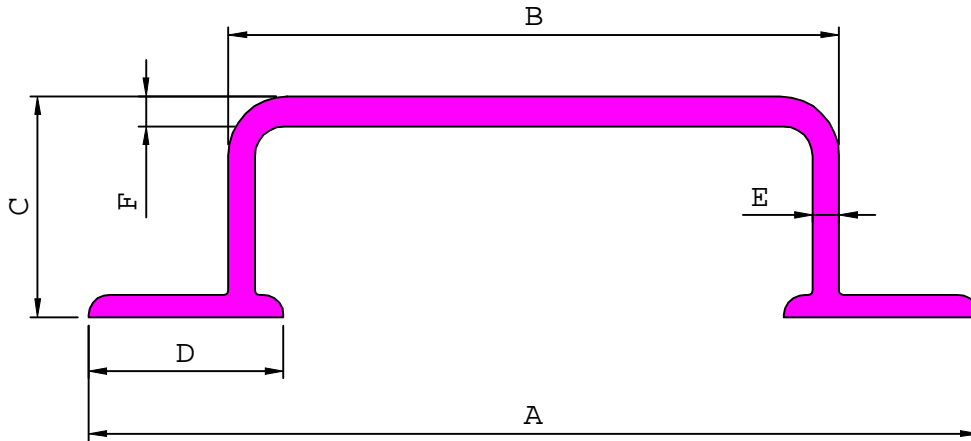

| SL. No. | Section No. | A | B | C | D | E | F | Weight kg/m |
|---------|--------------|--------|--------|-------|-------|------|------|-------------|
| 1 | 18593 | 98.00 | 62.00 | 24.00 | 24.00 | 2.37 | 2.37 | 0.875 |
| 2 | 18685 | 100.00 | 69.00 | 28.00 | 21.80 | 2.50 | 2.80 | 1.030 |
| 3 | 18686 | 119.50 | 81.00 | 29.50 | 25.25 | 2.00 | 2.10 | 0.939 |
| 4 | 18661 | 122.00 | 80.50 | 29.00 | 27.00 | 2.80 | 2.80 | 1.248 |
| 5 | 18655 | 123.00 | 83.50 | 31.00 | 26.50 | 3.70 | 3.70 | 1.659 |
| 6 | 18662 | 142.00 | 97.00 | 29.50 | 30.00 | 3.00 | 3.00 | 1.476 |
| 7 | 18654 | 147.00 | 107.50 | 31.00 | 26.50 | 3.70 | 3.70 | 1.899 |
| 8 | 18586 | 148.80 | 106.50 | 33.00 | 27.30 | 3.90 | 4.20 | 2.105 |
| 9 | 18619 | 150.00 | 110.00 | 34.00 | 30.00 | 3.45 | 3.60 | 1.995 |
| 10 | 18572 | 150.00 | 110.00 | 34.00 | 30.00 | 3.66 | 3.66 | 2.127 |
| 11 | 18620 | 150.00 | 110.00 | 34.00 | 30.00 | 4.00 | 4.10 | 2.248 |

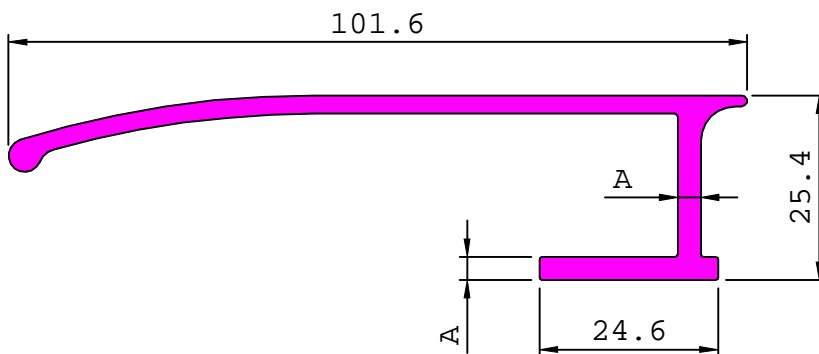

| SL. No. | Section No. | A | Weight kg/m |
|---------|--------------|------|-------------|
| 1 | 18553 | 3.18 | 1.093 |
| 2 | 18604 | 2.10 | 0.852 |

HANDLE SECTIONS

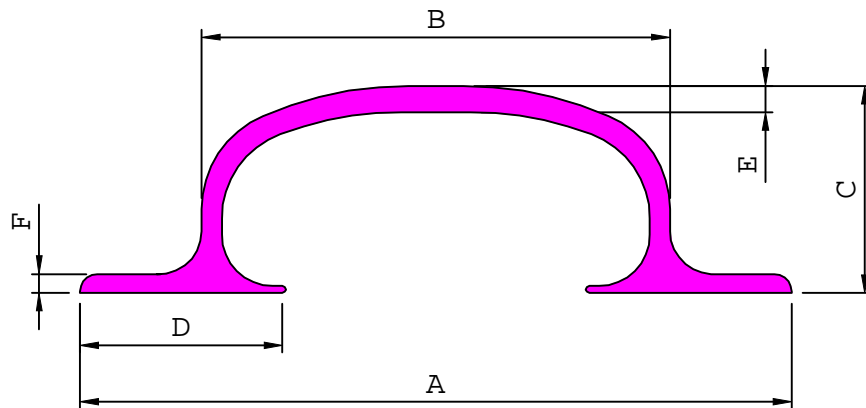

| SL. No. | Section No. | A | B | C | D | E | F | Weight kg/m |
|---------|--------------|--------|-------|-------|-------|------|------|-------------|
| 1 | 18675 | 100.60 | 65.50 | 28.00 | 25.00 | 2.00 | 1.55 | 0.797 |
| 2 | 18660 | 101.00 | 65.30 | 28.10 | 28.00 | 2.65 | 2.10 | 1.018 |
| 3 | 18672 | 120.00 | 80.90 | 32.80 | 25.80 | 2.00 | 1.65 | 0.907 |
| 4 | 18653 | 120.00 | 81.00 | 37.00 | 26.50 | 2.95 | 2.00 | 1.335 |
| 5 | 18657 | 120.00 | 82.00 | 32.70 | 25.50 | 2.40 | 2.20 | 1.097 |
| 6 | 18651 | 121.00 | 81.00 | 33.50 | 27.00 | 2.65 | 2.00 | 1.172 |
| 7 | 18684 | 121.00 | 81.80 | 32.30 | 26.00 | 2.20 | 1.80 | 0.966 |
| 8 | 18683 | 121.00 | 81.80 | 32.30 | 26.75 | 2.70 | 2.15 | 1.179 |
| 9 | 18611 | 123.00 | 82.50 | 34.50 | 30.00 | 2.45 | 2.20 | 1.258 |
| 10 | 18674 | 125.30 | 82.80 | 37.00 | 34.50 | 3.45 | 2.95 | 1.748 |
| 11 | 18671 | 125.50 | 84.30 | 34.50 | 28.00 | 2.70 | 2.50 | 1.293 |
| 12 | 18648 | 126.50 | 84.00 | 36.50 | 35.00 | 3.10 | 2.70 | 1.598 |
| 13 | 18678 | 127.00 | 83.00 | 37.00 | 34.00 | 2.90 | 2.35 | 1.504 |
| 14 | 18676 | 127.00 | 84.00 | 36.50 | 33.00 | 2.45 | 2.60 | 1.424 |
| 15 | 18613 | 128.00 | 84.00 | 37.00 | 30.00 | 3.50 | 3.10 | 1.724 |
| 16 | 18682 | 138.00 | 97.70 | 34.50 | 27.00 | 2.20 | 1.80 | 1.127 |
| 17 | 18681 | 138.40 | 98.20 | 33.80 | 26.90 | 2.70 | 2.20 | 1.309 |
| 18 | 18680 | 141.50 | 97.10 | 36.80 | 34.50 | 2.90 | 2.50 | 1.612 |
| 19 | 18649 | 140.00 | 98.50 | 35.00 | 27.00 | 2.55 | 2.40 | 1.328 |
| 20 | 18652 | 140.00 | 98.00 | 35.00 | 28.20 | 2.95 | 2.70 | 1.524 |
| 21 | 18656 | 140.00 | 98.50 | 31.70 | 27.00 | 2.50 | 2.30 | 1.252 |
| 22 | 18647 | 141.00 | 98.40 | 38.40 | 38.10 | 3.10 | 2.70 | 1.815 |
| 23 | 18673 | 142.00 | 98.00 | 35.00 | 38.50 | 3.60 | 3.60 | 2.051 |
| 24 | 18650 | 142.40 | 98.40 | 38.40 | 38.80 | 3.10 | 2.80 | 1.837 |
| 25 | 18677 | 145.00 | 98.00 | 36.50 | 33.00 | 2.95 | 3.00 | 1.664 |

HANDLE SECTIONS

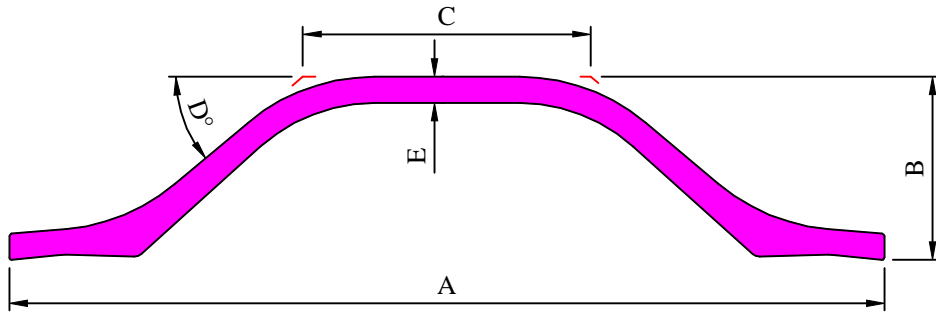

| SL. No. | Section No. | A | B | C | D | E | Weight kg/m |
|---------|--------------|--------|-------|-------|-------|------|-------------|
| 1 | 18663 | 133.80 | 28.00 | 44.00 | 40.00 | 4.00 | 1.742 |
| 2 | 18664 | 154.50 | 27.30 | 64.00 | 38.50 | 4.10 | 2.031 |

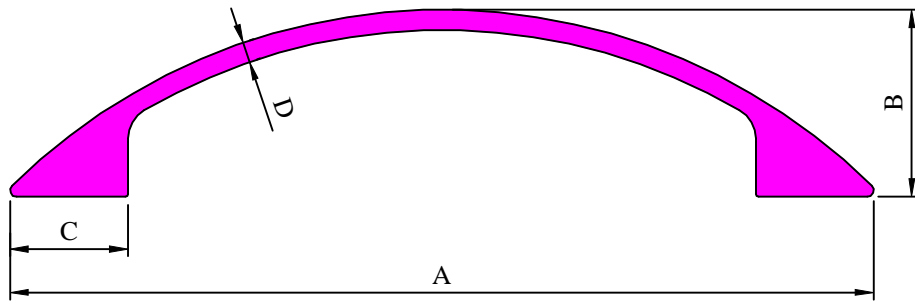

| SL. No. | Section No. | A | B | C | D | Weight kg/m |
|---------|--------------|--------|-------|-------|------|-------------|
| 1 | 18665 | 132.00 | 28.60 | 18.00 | 3.10 | 1.724 |
| 2 | 18666 | 151.80 | 29.00 | 18.30 | 3.20 | 1.855 |

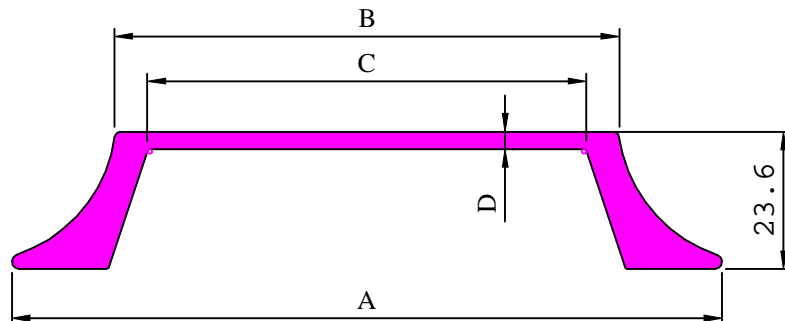

| SL. No. | Section No. | A | B | C | D | Weight kg/m |
|---------|--------------|--------|--------|--------|------|-------------|
| 1 | 18667 | 122.15 | 86.80 | 75.50 | 3.00 | 1.748 |
| 2 | 18668 | 150.75 | 114.00 | 102.60 | 3.20 | 2.063 |

HANDLE SECTIONS

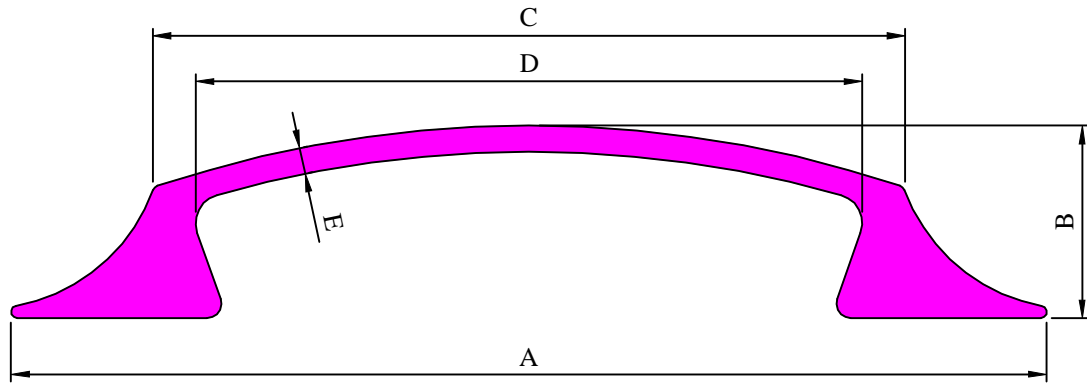

| SL. No. | Section No. | A | B | C | D | E | Weight kg/m |
|---------|--------------|--------|-------|--------|--------|------|-------------|
| 1 | 18669 | 142.50 | 26.50 | 103.50 | 91.70 | 3.60 | 2.340 |
| 2 | 18670 | 164.25 | 28.00 | 128.70 | 111.50 | 3.50 | 2.771 |

HANDLE SECTIONS

18645

4.700 kg/m

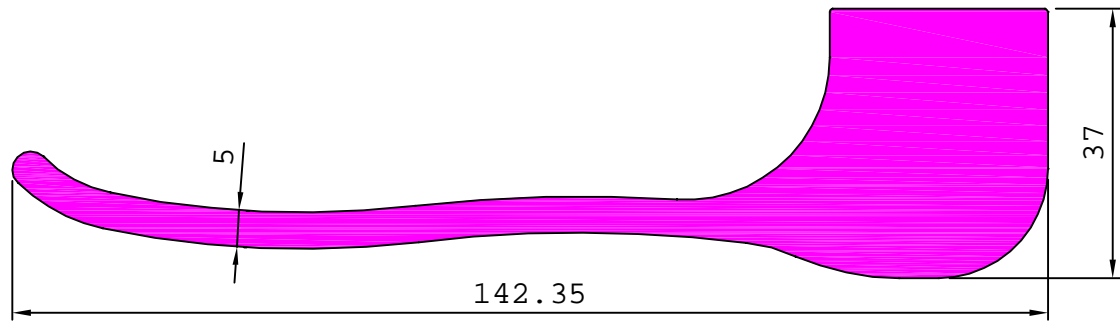

18643

7.668 kg/m

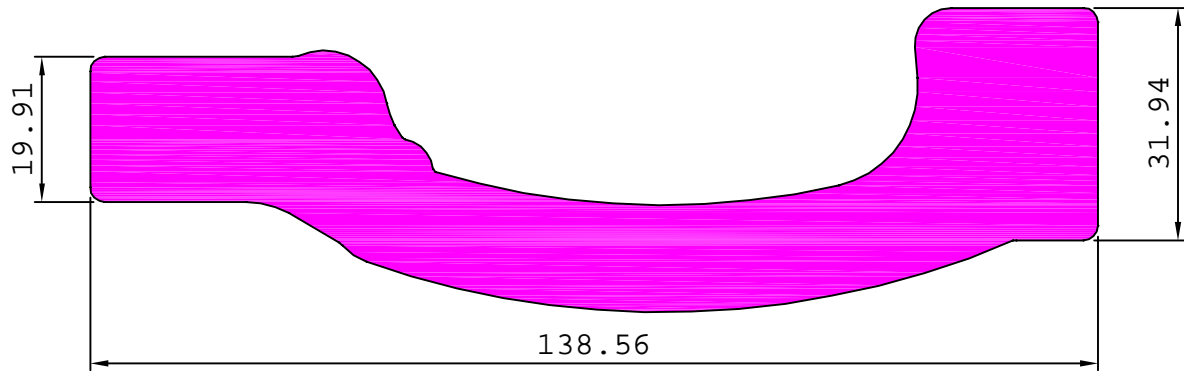

18644

9.441 kg/m

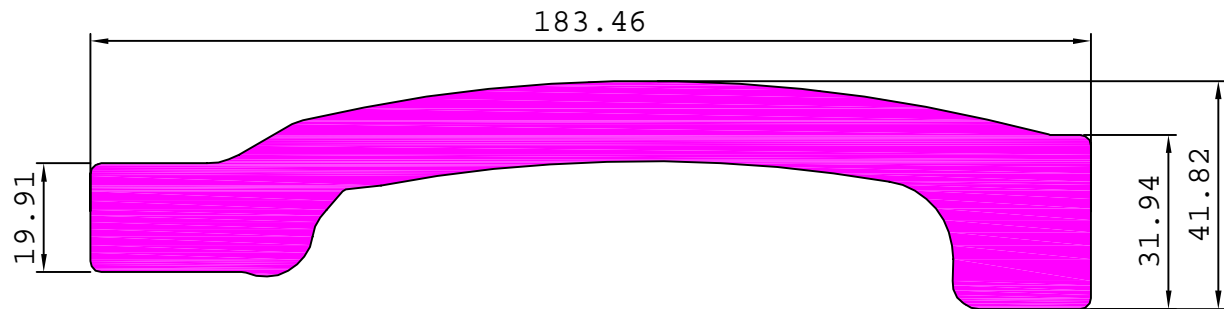

29426

13.076 kg/m

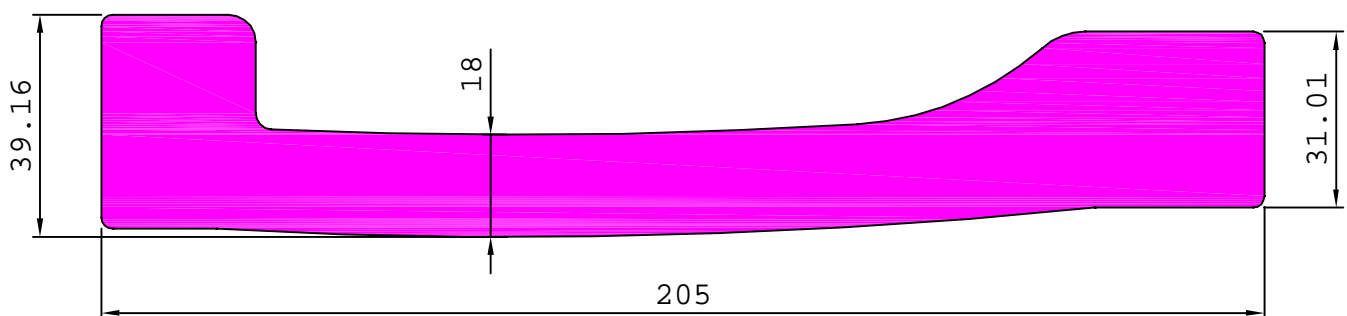

HANDLE SECTIONS

18646

1.579 kg/m

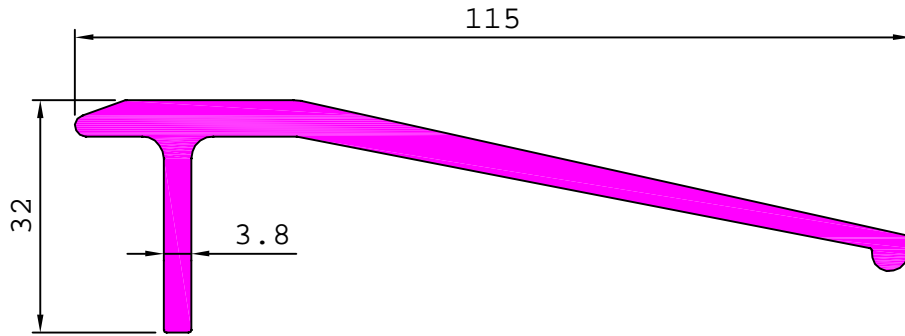

18658

1.411 kg/m

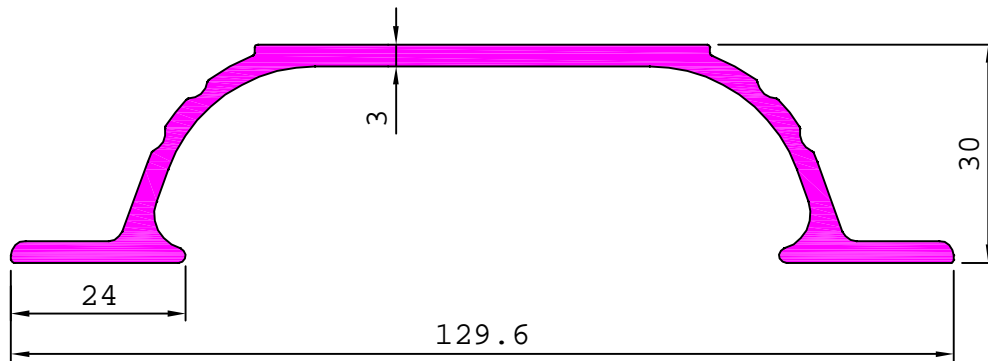

18659

1.613 kg/m

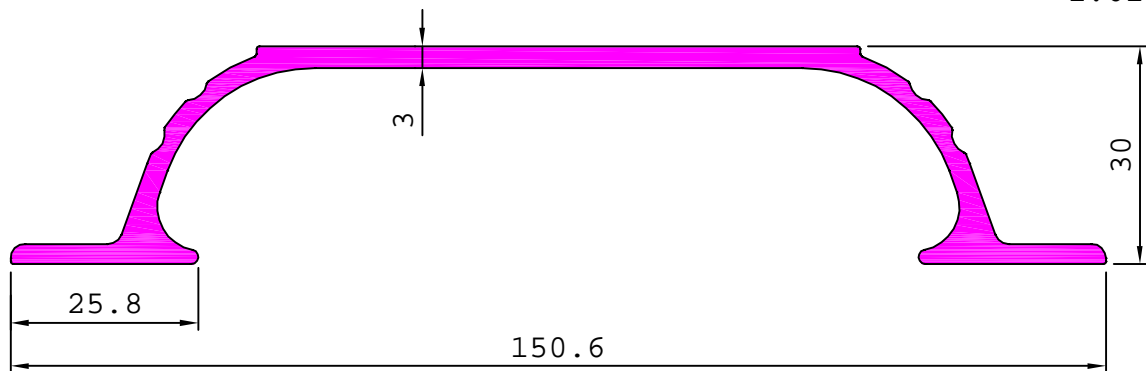

18679

4.240 kg/m

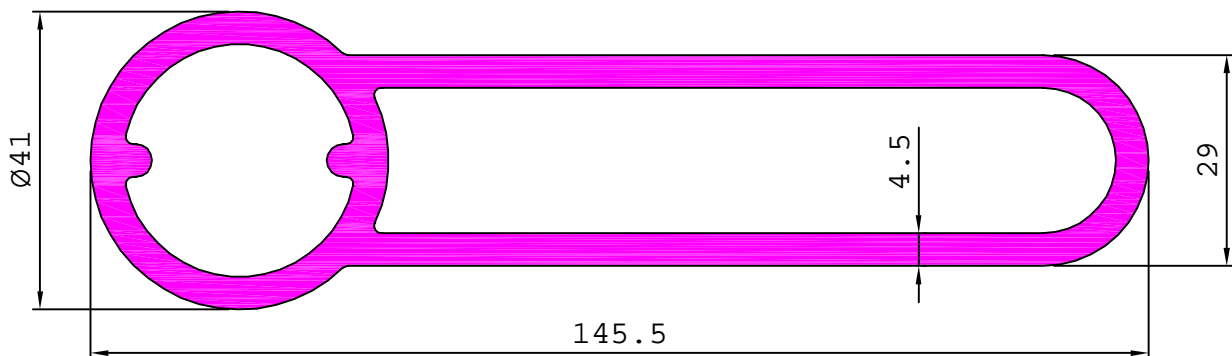

HANDLE SECTIONS

18641

0.707 kg/m

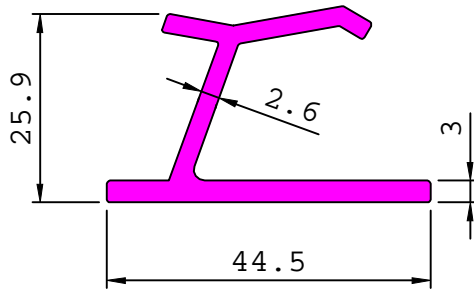

18576

1.074 kg/m

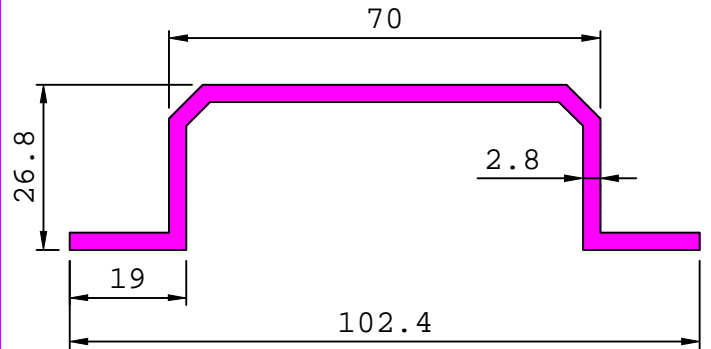

18558

1.438 kg/m

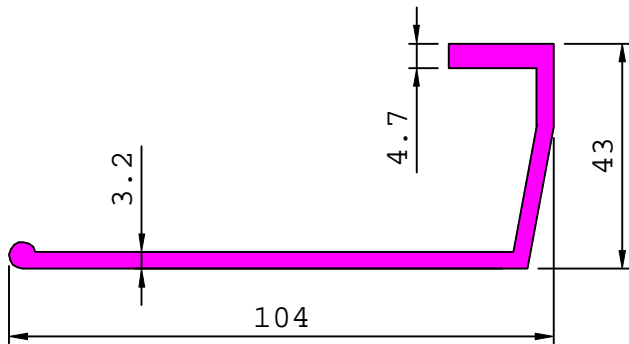

18560

1.709 kg/m

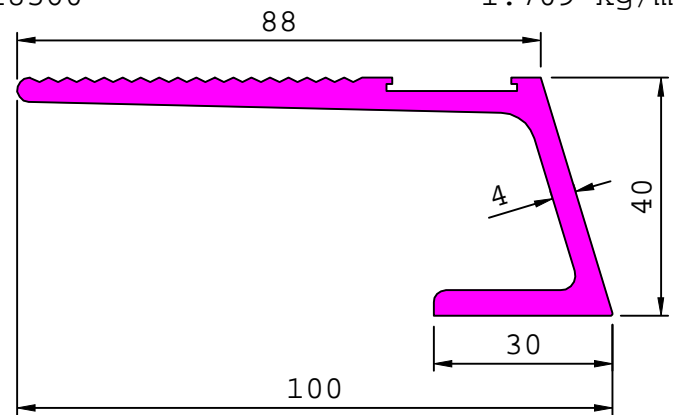

18570

0.942 kg/m

