

GENERAL SHAPE

MISCELLANEOUS BARS

TAPER FLAT BAR

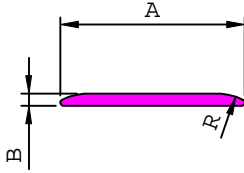

| SL. No. | Section No. | A | B | R | Weight kg/m |
|---------|--------------|-------|------|------|-------------|
| 1 | 12095 | 24.75 | 1.17 | 1.00 | 0.077 |
| 2 | 12249 | 25.40 | 1.42 | 6.00 | 0.093 |
| 3 | 12016 | 25.40 | 1.60 | 6.00 | 0.104 |
| 4 | 12017 | 25.40 | 1.88 | 6.00 | 0.120 |
| 5 | 12294 | 25.40 | 2.34 | 6.00 | 0.148 |
| 6 | 12295 | 25.40 | 2.74 | 6.00 | 0.171 |

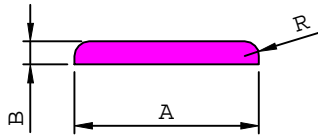

| SL. No. | Section No. | A | B | R | Weight kg/m |
|---------|--------------|-------|------|------|-------------|
| 1 | 12089 | 25.00 | 2.95 | 2.00 | 0.194 |
| 2 | 12010 | 25.40 | 3.18 | 1.98 | 0.213 |

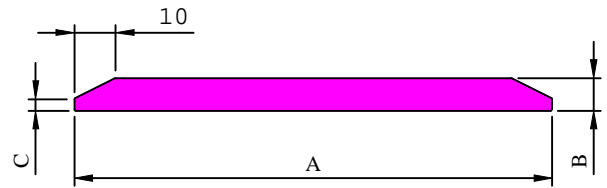

| SL. No. | Section No. | A | B | C | Weight kg/m |
|---------|--------------|--------|-------|------|-------------|
| 1 | 38656 | 285.00 | 8.00 | 3.00 | 6.021 |
| 2 | S5651 | 310.00 | 8.00 | 3.00 | 6.561 |
| 3 | S5652 | 350.00 | 10.00 | 4.00 | 9.288 |

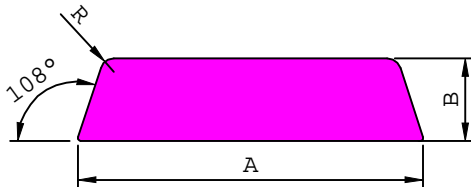

| SL. No. | Section No. | A | B | R1 | Weight kg/m |
|---------|--------------|-------|-------|------|-------------|
| 1 | 12122 | 40.00 | 8.00 | 2.00 | 0.812 |
| 2 | 12120 | 50.00 | 12.00 | 2.00 | 1.501 |
| 3 | 12121 | 50.00 | 12.00 | 8.00 | 1.469 |

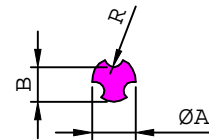

| SL. No. | Section No. | A | B | R | Weight kg/m |
|---------|--------------|------|------|------|-------------|
| 1 | 12049 | 5.60 | 4.55 | 1.25 | 0.052 |
| 2 | 12024 | 5.80 | 4.30 | 1.50 | 0.045 |
| 3 | 12004 | 6.00 | 4.75 | 1.25 | 0.057 |
| 4 | 12021 | 6.00 | 4.50 | 1.20 | 0.053 |

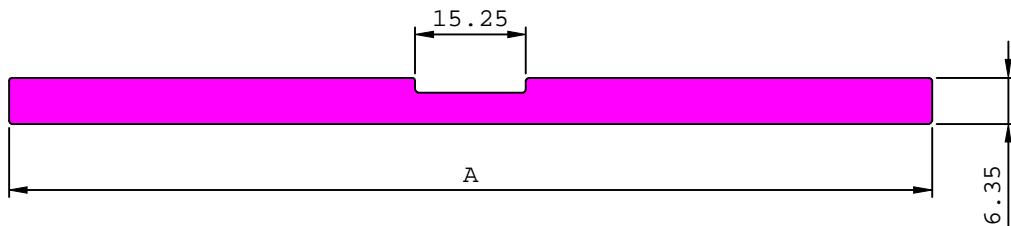

| SL. No. | Section No. | A | Weight kg/m |
|---------|--------------|--------|-------------|
| 1 | 12326 | 101.60 | 1.658 |
| 2 | 12325 | 127.00 | 2.093 |

GENERAL SHAPE

MISCELLANEOUS BARS

12006

0.483 kg/m

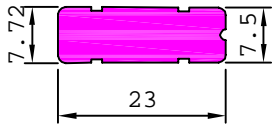

12007

0.584 kg/m

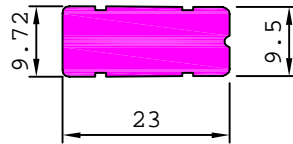

12008

0.801 kg/m

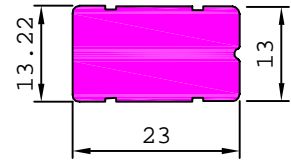

12149

1.120 kg/m

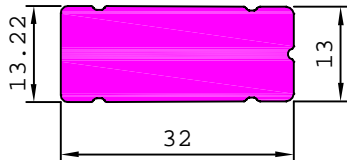

12152

0.811 kg/m

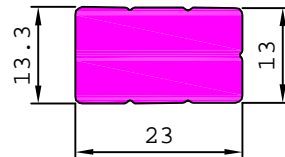

S4238

1.228 kg/m

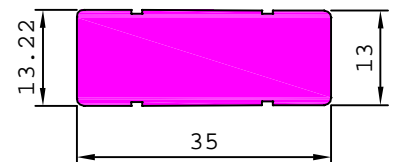

GENERAL SHAPE

MISCELLANEOUS BARS

12094

0.196 kg/m

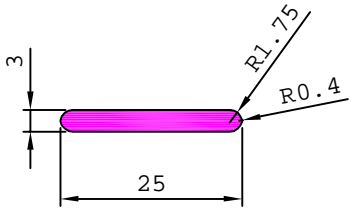

12011

0.040 kg/m

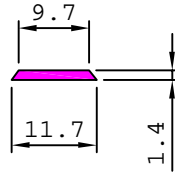

12107

0.495 kg/m

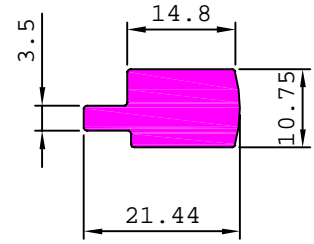

12106

0.424 kg/m

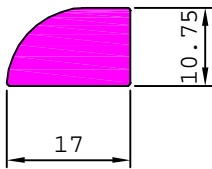

S6461

0.047 kg/m

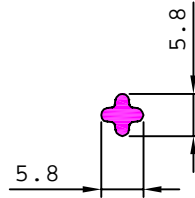

S5165

0.044 kg/m

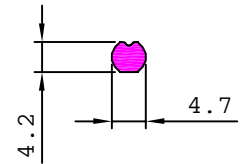

12225

0.253 kg/m

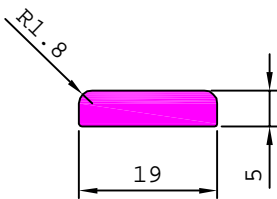

12247

0.031 kg/m

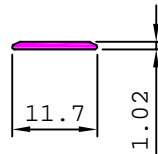

12248

0.068 kg/m

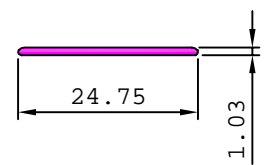

12026

0.197 kg/m

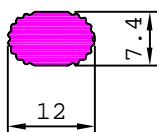

S4164

0.063 kg/m

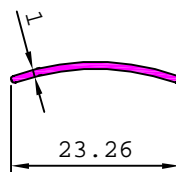

12277

0.266 kg/m

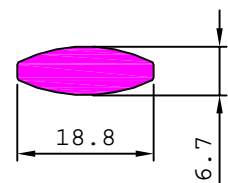

GENERAL SHAPE

MISCELLANEOUS BARS

12151

0.267 kg/m

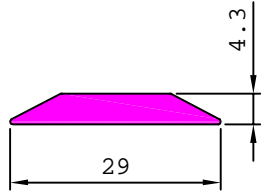

12321

0.272 kg/m

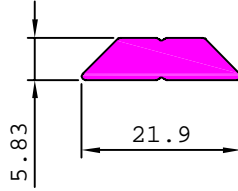

12166

1.271 kg/m

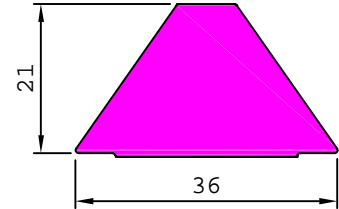

S5384

1.174 kg/m

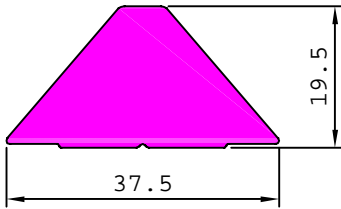

S5385

0.506 kg/m

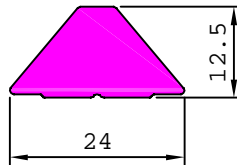

28924

0.116 kg/m

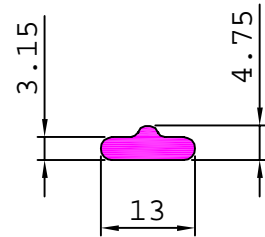

12286

0.149 kg/m

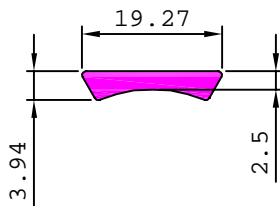

12296

0.139 kg/m

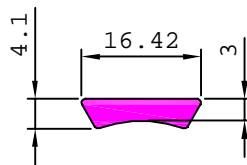

12313

0.091 kg/m

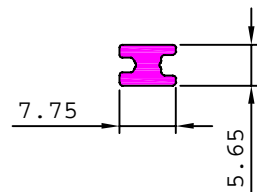

12093

0.381 kg/m

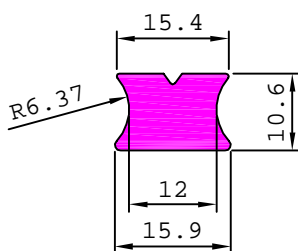

S6310

0.110 kg/m

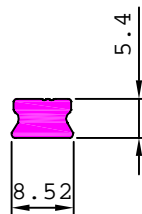

12194

0.168 kg/m

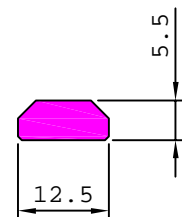

GENERAL SHAPE

MISCELLANEOUS BARS

G012356

25.692 kg/m

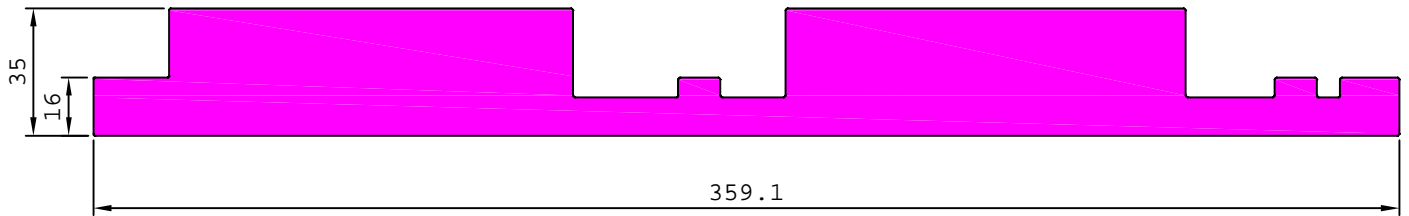

12357

1.841 kg/m

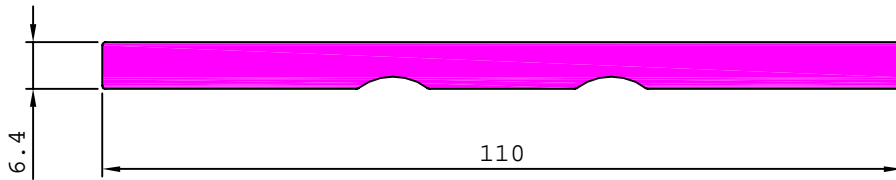

12306

41.431 kg/m

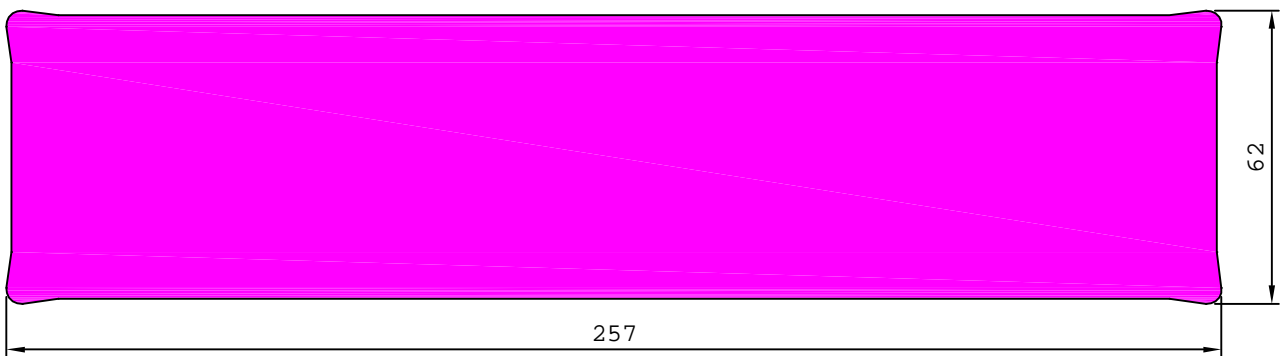

12346

14.850 kg/m

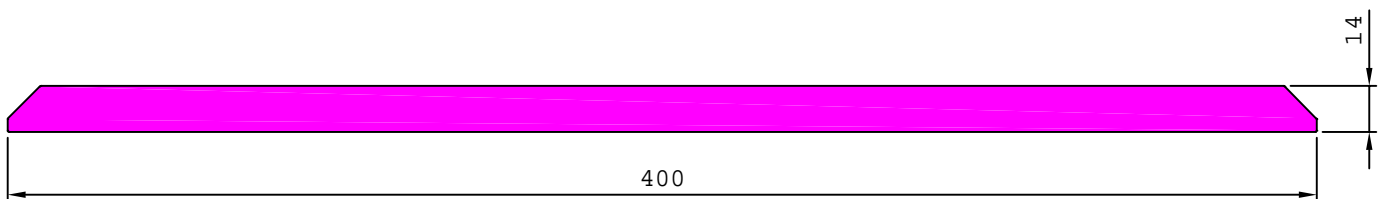

GENERAL SHAPE

MISCELLANEOUS BARS

12287

0.720 kg/m

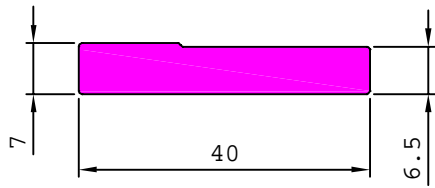

12184

2.505 kg/m

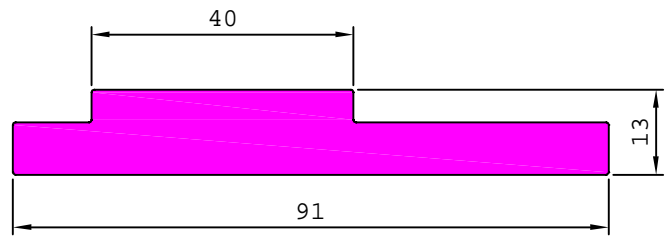

12360

4.628 kg/m

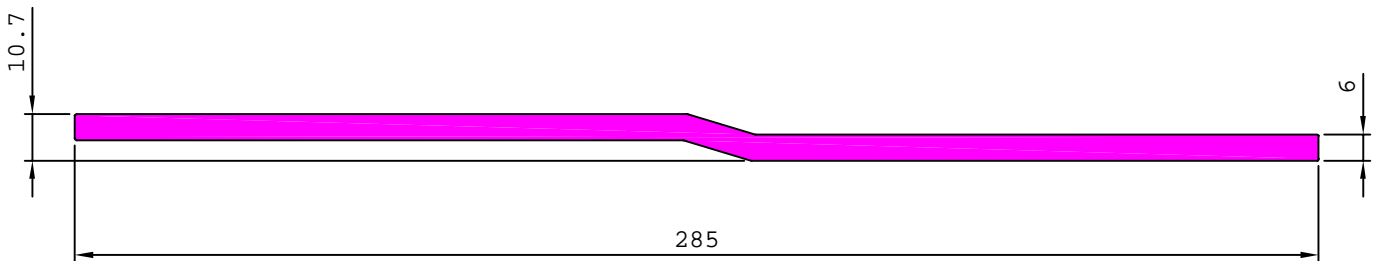

12378

24.918 kg/m

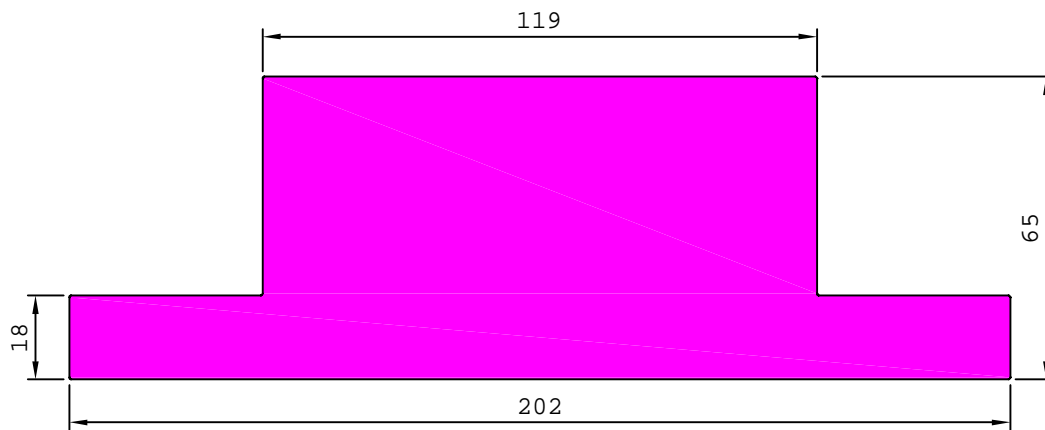

12384

40.695 kg/m

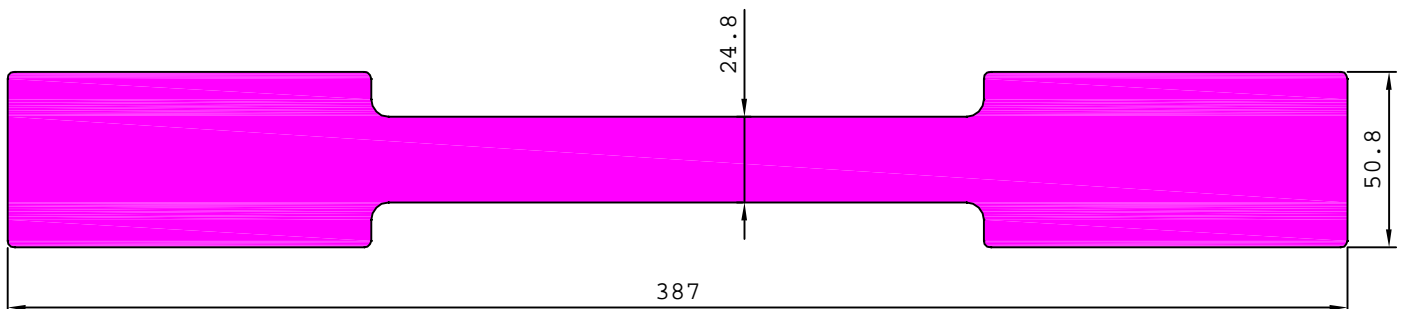

GENERAL SHAPE

MISCELLANEOUS BARS

12174

2.311 kg/m

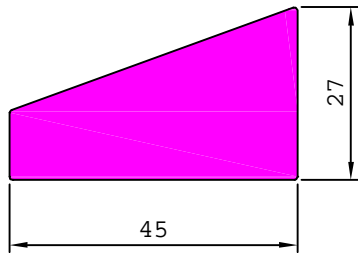

12047

2.009 kg/m

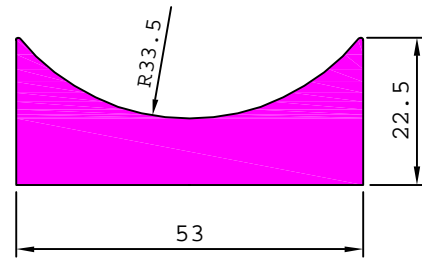

27885

10.099 kg/m

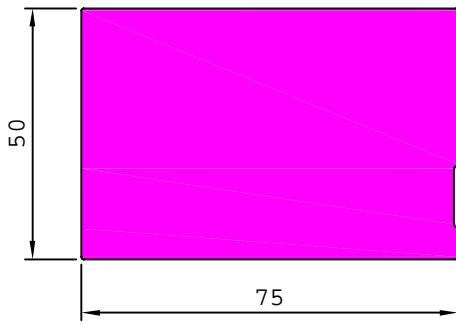

12332

1.568 kg/m

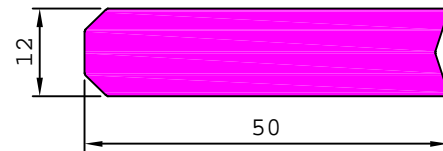

12299

0.372 kg/m

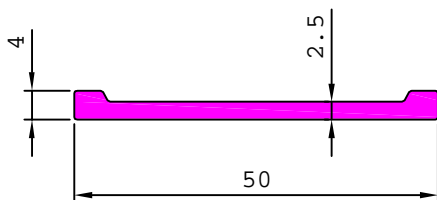

12314

4.412 kg/m

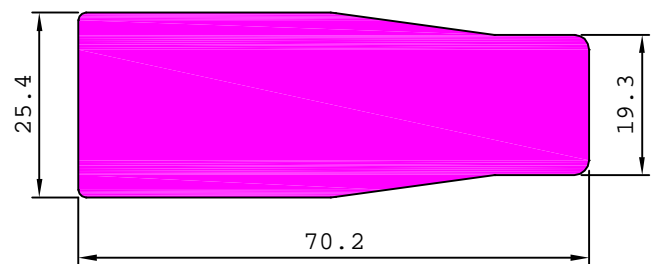

12288

0.289 kg/m

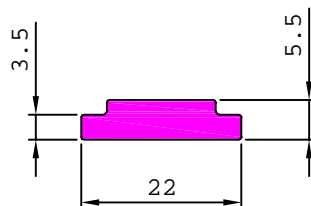

12347

0.550 kg/m

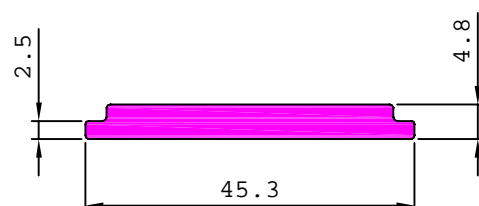

GENERAL SHAPE

MISCELLANEOUS BARS

12403

3.132 kg/m

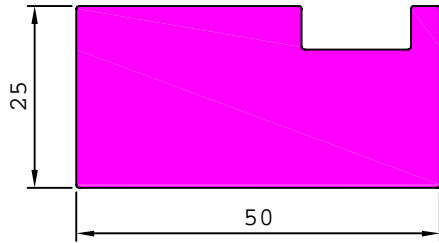

G100232

0.254 kg/m

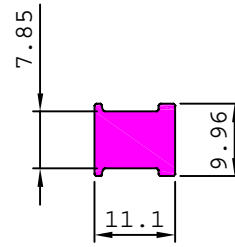

G100481

17.143 kg/m

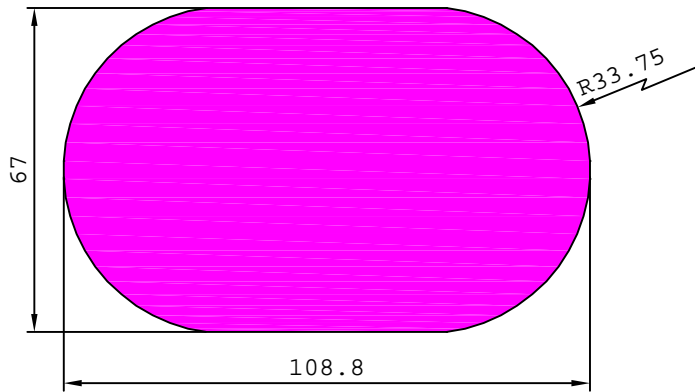

G100676

64.726 kg/m

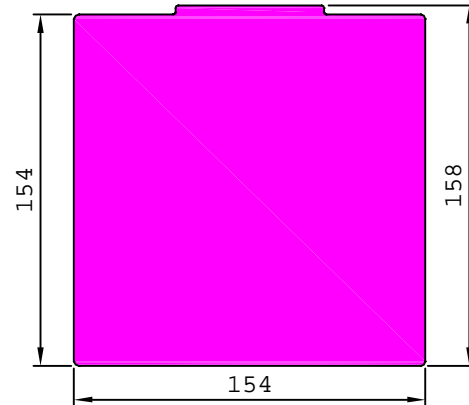

G100765

2.438 kg/m

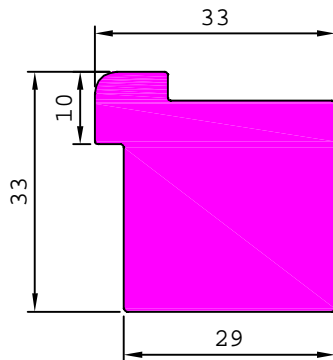

G100766

2.388 kg/m

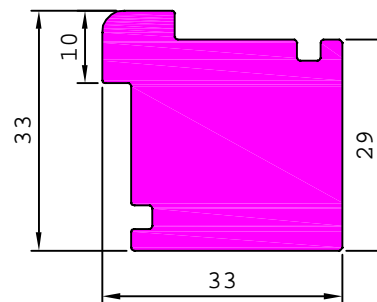

G100997

6.751 kg/m

